



— MODEL — X144D

e-FlowMeter with Display



Patented

- Plug and Play Metering
- Built-In LCD Touch Screen
- Can be factory assembled on a new valve
- Alleviates the need for an in-line meter and the associated installation costs
- IP68 Submersible
- Stainless Steel Construction
- Independent laboratory tested:
 - Utah State University, Imperial College - London

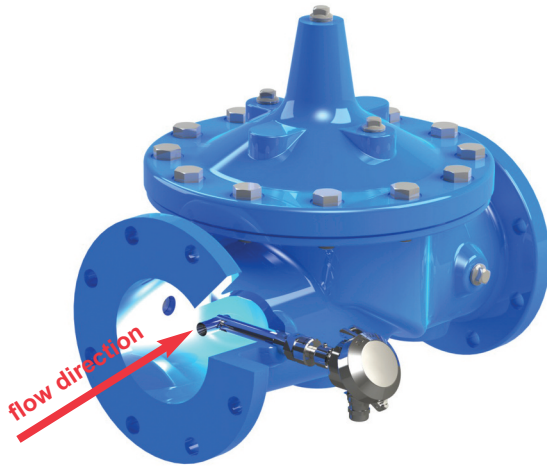

Installation view of the X144D e-FlowMeter

Note: Consult Factory for Angle Pattern Applications

Frequency Measurement

The X144D e-FlowMeter uses the vortex shedding method to measure flow. The meter is inserted into the inlet tapping of the valve and the measurement cylinder is oriented parallel to the direction of flow. The flow enters the measurement cylinder where it encounters the bluff body, generating vortices, which in turn, deflects off the piezoelectric sensor.

The sensor counts the vortices and communicates the data to the meter's integral circuit board. The flow data signal is converted to 4-20mA, or transistor (NPN) pulse, depending on the desired application.

The Cla-Val Model X144D e-FlowMeter is a vortex shedding insertion flow meter designed to be retrofitted into a Cla-Val Automatic Control Valve to provide accurate flow measurement data without the need to install a separate meter.

Configured for installation in the inlet tapping of a Cla-Val Automatic Control Valve, the X144D can be used in valves directly downstream of a flow disturbance such as elbows, valves or a reducer. (See page 2 for installation guidelines)

The X144D e-FlowMeter employs an innovative swivel mechanism which allows the meter to be inserted into tappings as small as 1/2-inch. For applications involving installation in close proximity to pump discharge, please consult factory with details.

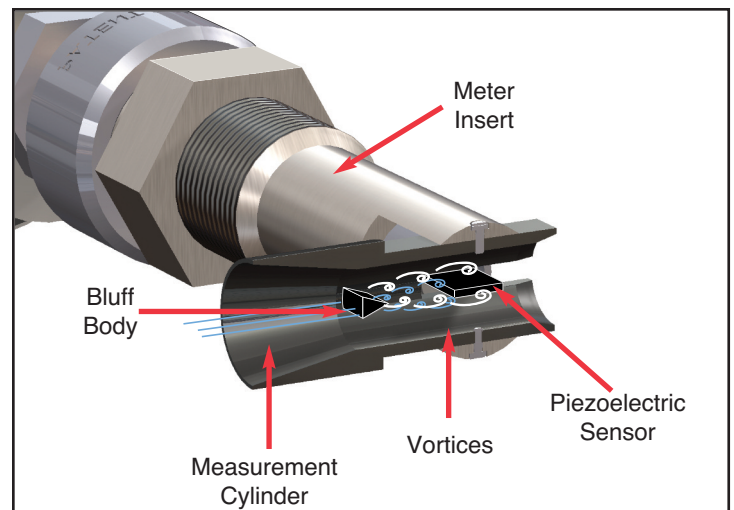

Installation Guidelines and Typical Applications

Installation Locations

For optimum performance, it is recommended that the valve in which the X144D e-FlowMeter is installed be located as shown below.

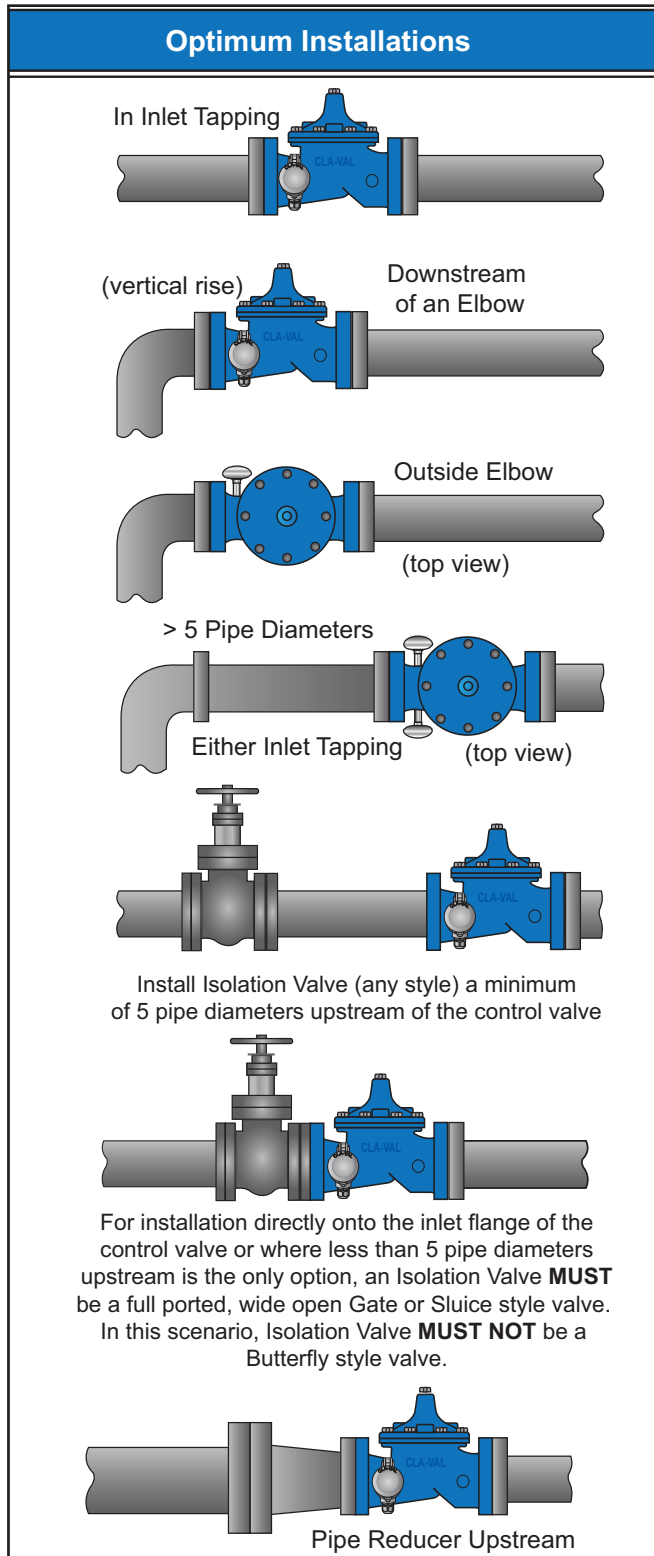

Installation Notes:

- Consult factory for other installation configurations
- Do not use butterfly valves as isolation valves adjacent to X144D installations

Typical Applications

The X144D e-FlowMeter is ideal for installation in any application where metering is desired.

Combining additional Cla-Val electronic products with the X144D e-FlowMeter provides even more access to valve performance data installed in remote locations.

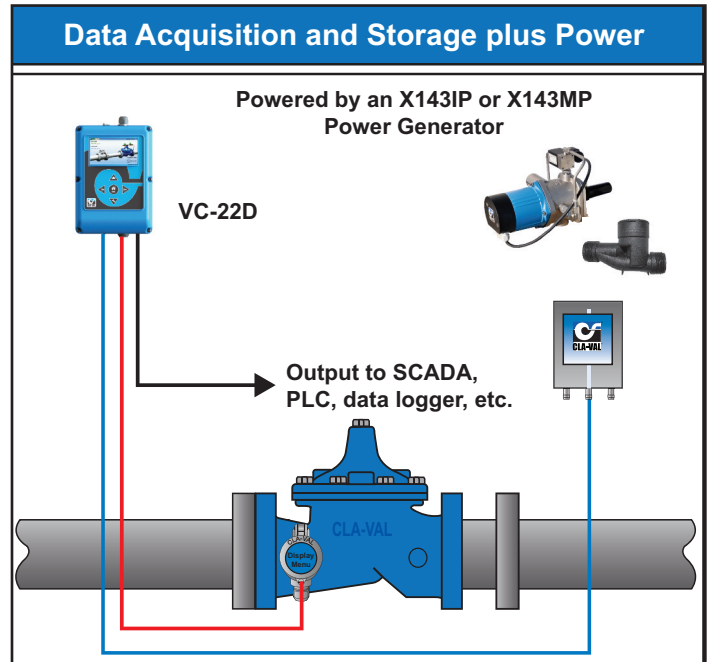

Data Acquisition and Storage using Cla-Val Power Generator

- The X144D e-FlowMeter connects to most commercially available loggers with the choice of 4-20mA or pulse output
- The VC-22D Controller and X145 e-Display are ideal companions to the X144D e-flowMeter, providing access to real-time data
- The VC-22D Controller, e-Display and e-FlowMeter can be powered by the X143 Series Power Generators

Typical Menus

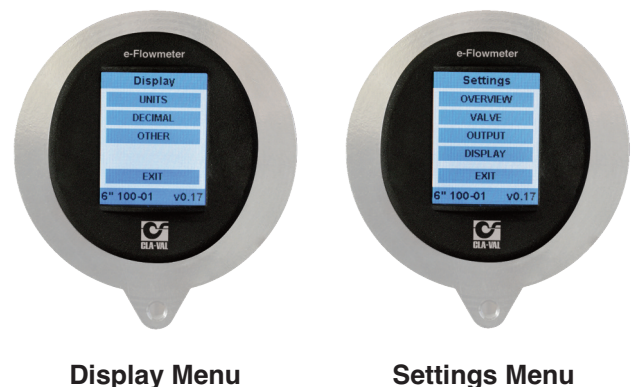

X144D Dimensions

X144D Sizes		1			2		3		4						
Full Port Valve Sizes (inches)		2	2-1/2	3	4	6	8	10	12	14	16	18	20	24	30
Reduced Port Valve Sizes (inches)		4	4	4	6	8	10	12	14	16	18	20	24	CF	CF
Overall Length (in inches)	A	8.85	8.85	8.85	9.45	9.45	13.18	13.18	17.91	17.91	17.91	17.91	17.91	17.91	17.91
Insertion Length (in inches)	B	2.3	2.3	2.3	2.8	2.8	6.8	6.8	11.25	11.25	11.25	11.25	11.25	11.25	11.25
Pipe Thread (NPT)	C	1/2	1/2	1/2	3/4	3/4	1	1	1	1	1	1	1	1	1
Overall Width (in inches)	D	3.25	3.25	3.25	3.25	3.25	3.25	3.25	3.25	3.25	3.25	3.25	3.25	3.25	3.25

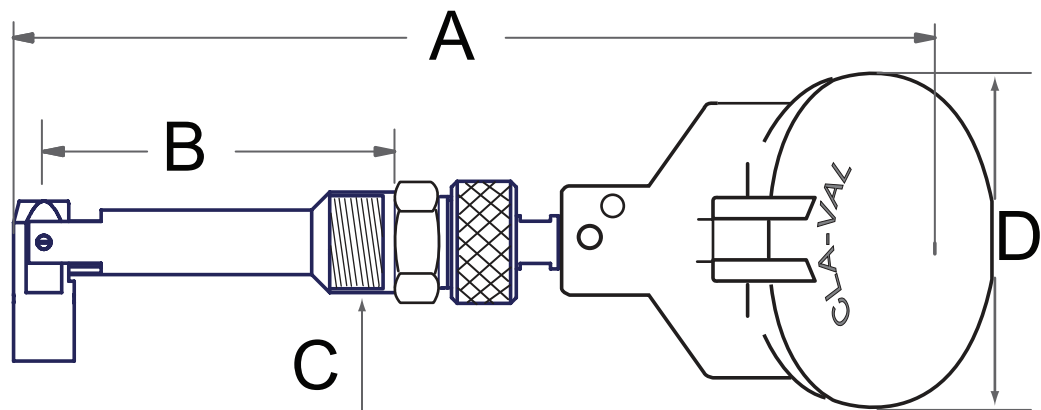

*2" X144D e-FlowMeter may be installed on new valves only. Consult factory for larger applications

Typical Performance

X144D e-FlowMeter vs. Mag Meter

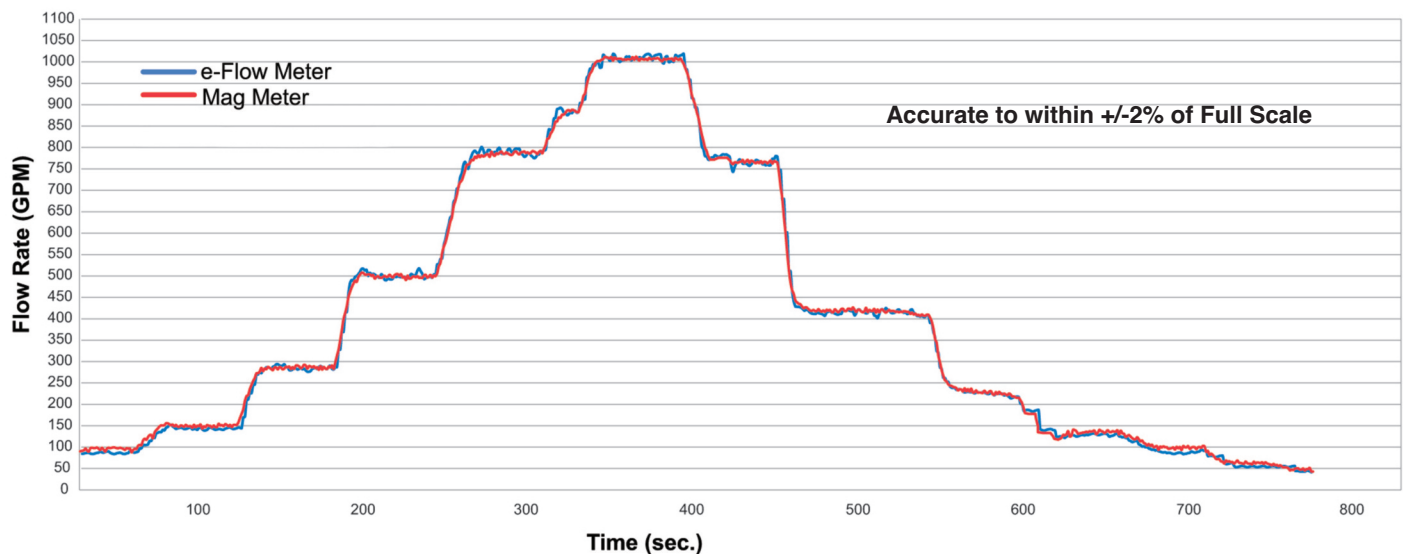

Product Details

Insertion Tool and Locking Ring

- Required for installation
- Tool allows the proper installation and alignment of the bluff body to be parallel to upstream flow

Power Requirement

- 12/24 VDC, 1.0 Watts minimum

X144D e-Flow Meter Sizing

- The X144D threads directly into the inlet tapping of a Cla-Val Control Valve. The size of the e-FlowMeter is dependent on the specific valve size for which it has been calibrated - no additional fittings are required.

See dimension chart on previous page.

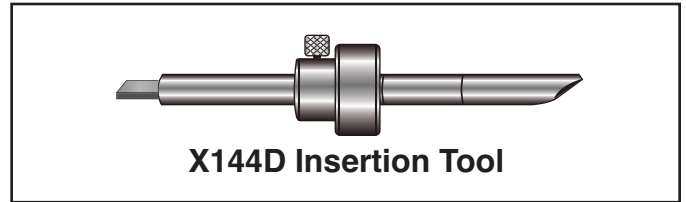

Cabling

- The unit is supplied with 30 feet of shielded cable.

Maximum Operating Pressure : 400 PSI

X144D e-FlowMeter Operational Flow Range = from 0.5 ft/s to 20 ft/s

X144D e-FlowMeter Analog Range (4-20mA Scaling): Factory Settings

Port Style	Line Size inches (mm)	**2" (50) (100-49 Body)	2-1/2" (65)	3" (80)	4" (100)	6" (150)	8" (200)	10" (250)	12" (300)	14" (350)	16" (400)	18" (450)	20" (500)	24" (600)	30" (750)
Full Port Valves 4mA = 0 (GPM - l/s)	20mA Range (GPM)	260	375	575	1000	2250	3900	6000	8750	10500	14000	17500	22000	31000	52000
	20mA Range (l/s)	16.4	23.7	36.3	63.1	140	245	380	550	660	880	1100	1390	1950	3280
Full Port Pulse Weight*	Gal/Pulse	5	6.5	9.5	17	38	65	100	150	175	235	290	365	515	865
	l/Pulse	19	25	36	65	145	245	380	565	660	890	1100	1380	1950	3275
Reduced Port Valves 4mA = 0 (GPM- l/s)	20mA Range (GPM)	Not Available			675	1600	2900	4500	5650	7750	9350	Consult Factory			
	20mA Range (l/s)				42.5	100	180	285	355	490	590				
Reduced Port Valves Pulse Weight*	Gal/Pulse				11.5	26	48	75	95	130	155				
	l/Pulse				44	99	180	285	360	495	585				

* Pulse Width = 250ms

**2" X144D e-FlowMeter may be installed on new valves only



CLA-VAL™

E-X144D (R 05/2019)

CLA-VAL

1701 Placentia Avenue • Costa Mesa, CA 92627

800-942-6326 • Fax: 949-548-5441 • www.cla-val.com • info@cla-val.com

CLA-VAL CANADA

4687 Christie Drive
Beamsville, Ontario
Canada L0R 1B4
Phone: 905-563-4963
Fax: 905-563-4040
E-mail sales@cla-val.ca

CLA-VAL EUROPE

Chemin des Mésanges 1
CH-1032 Romanel/
Lausanne, Switzerland
Phone: 41-21-643-15-55
E-mail: cla-val@cla-val.ch

CLA-VAL UK

Dainton House, Goods Station Road
Tunbridge Wells
Kent TN11 2 DH England
Phone: 44-1892-514-400
E-mail: info@cla-val.co.uk

CLA-VAL FRANCE

Porte du Grand Lyon 1
ZAC du Champ du Périon
France - 01700 Neyron
Phone: 33-4-72-25-92-93
E-mail: cla-val@cla-val.fr

©COPYRIGHT CLA-VAL 2019 Printed in USA Specifications subject to change without notice.