



Closed Body Pinch Valve



Quality Features at No Extra Cost!

- Short face-to-face
- Full port area
- Center sleeve closure
- Tight shut-off on solids
- Over pinch guard
- Positive pull opening tabs
- Valve position clearly visible

Heavy Construction at No Extra Cost!

- Easy to operate at high pressure
- Lubricated stem and bearing pad
- Stainless steel guide rods
- Reduced port sleeves for throttling flow
- Double wall sleeves for severe application

Many Synthetic Sleeve Materials Available:

Neoprene - Chlorobutyl - Hypalon - Buna-N® - Ethylene Propylene Rubber - Urethane and Viton™

When ordering above sleeve materials add the first letter of the material after the model number.

i.e. Model PV20.10N (N for Neoprene)

OPERATION

The Cla-Val Series PV20 Closed Body Pinch Valves provide simple means to manually control the flow of abrasive and corrosive slurries, liquids and solids. The valve operates by turning the handwheel clockwise to close, counter-clockwise to open like a gate valve, but unlike a gate valve the PV20 series valve has no packing or metal surfaces to wear out - the sleeve is merely squeezed to the desired open or closed position. The standard sleeve material, pure gum rubber, is made with reinforced polyester fabric for highest strength and longer lasting cycle life. Sizes 8" and larger are available with bevel gear operators suitable for automatic operation. Consult factory for details and assistance

MAINTENANCE

Cla-Val Pinch Valves are basically maintenance free because the sleeve isolates all mechanical parts from the media. The sleeve is the only part typically inventoried for future replacement.

WHEN ORDERING, Please specify following information:			
Flange	<input type="checkbox"/> ANSI	<input type="checkbox"/> ANSI 300	
Drilling	<input type="checkbox"/> PN 6	<input type="checkbox"/> PN 10	
	<input type="checkbox"/> PN 16	<input type="checkbox"/> BS 10	
	<input type="checkbox"/> Other		

Sleeves Available in Different Styles.

Pinch Valve Standard Sleeve

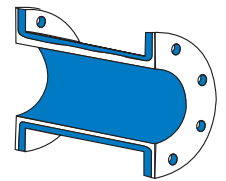

Pinch Valve Double Wall Sleeve

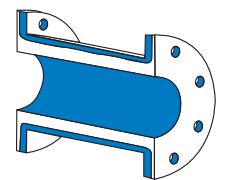

Pinch Valve Reduced Port Sleeve

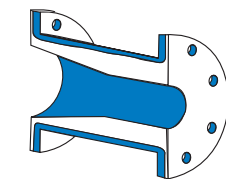

Series PV20 Closed Body Pinch Valves								
Model No	Pipe Size A	Length B	Working Pressure psi.	Width C	D	E	Diameter F	Weight (est.) lbs
PV20.100	1	5 1/2	150	5 1/4	3	7 1/2	4	12
PV20.150	1 1/2	6 1/2	150	5 3/8	4	7 1/2	4	25
PV20.2	2	7	150	7 1/8	4 1/2	9 3/8	8	34
PV20.250	2 1/2	7 1/2	150	9 3/4	5	9 3/8	8	43
PV20.3	3	8	150	8 1/4	5	10 1/2	8	52
PV20.4	4	9	150	9 1/2	5 1/2	12	12	123
PV20.5	5	10	125	12 1/2	6 1/2	16	11	200
PV20.6	6	10 1/2	125	13	8	18	18	300
PV20.8	8	16	75	18 1/2	10	22	22	345
PV20.10	10	20	75	22 1/2	11	24	22	410
PV20.12	12	24	75	25	12	25	22	472
PV20.14	14	28	50	29	14	29	30	588
PV20.16	16	32	50	33	15	32	30	930
PV20.18	18	36	50	35	16	35	36	1150
PV20.20	20	40	50	39	17	37	36	1300
PV20.24	24	48	50	50 1/2	23	43	48	1510

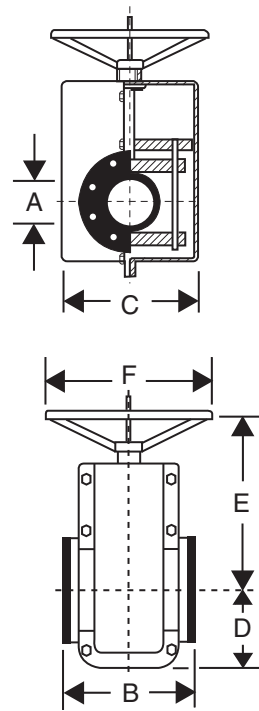

Sizes 6" and smaller conform to ANSI B16-10 FF Laying Length. Sizes 8" and larger available with bevel gear operators and custom fabricated housings. Consult factory for final dimensions.