

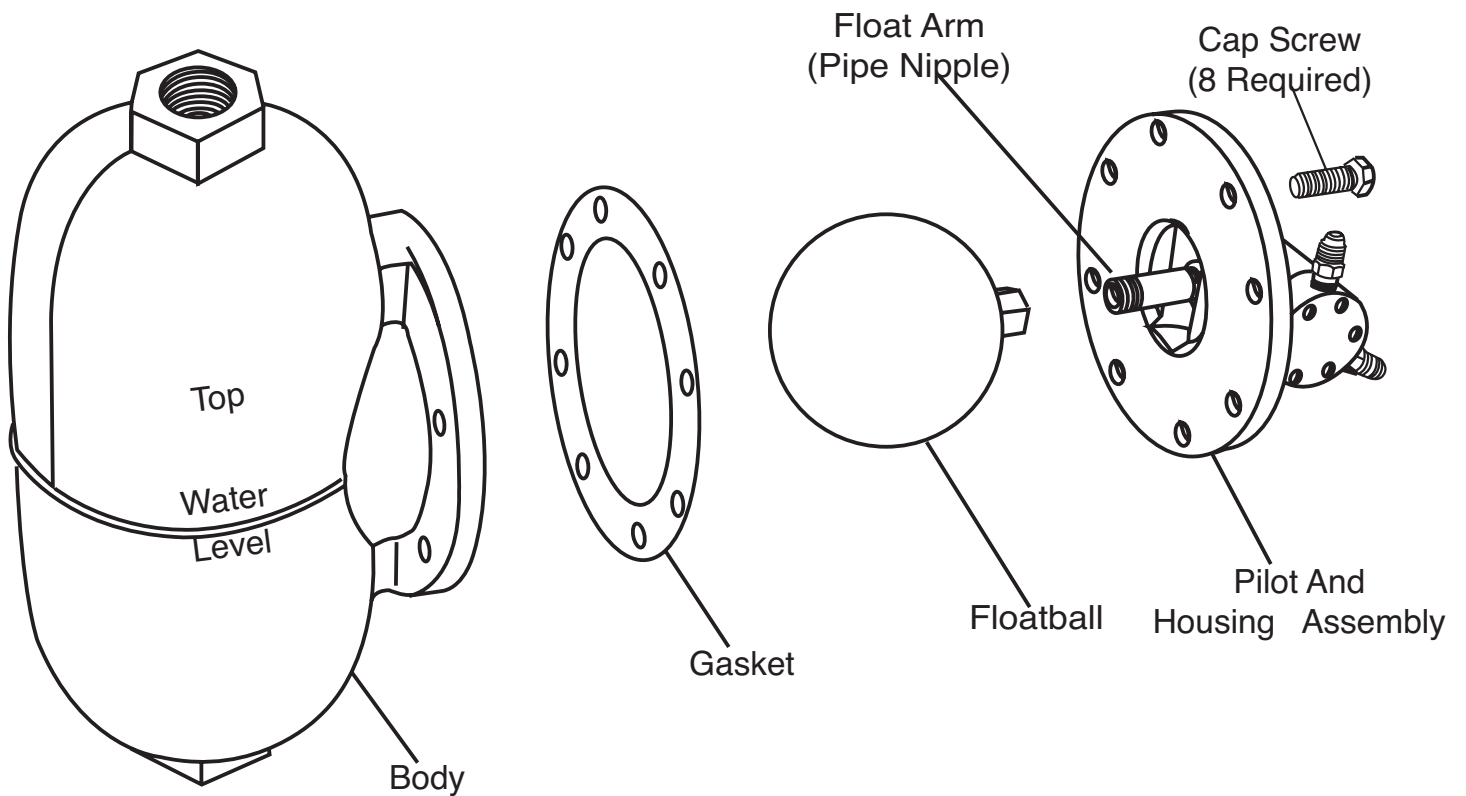

Model CFC2 FLOAT CHAMBER CONTROL



| Common Part | |
|------------------------|-------------------|
| Description | Material |
| Float Ball | S.S |
| *Gasket | Neoprene |
| Cap Screws 3/8-16 x7/8 | Steel Cad. Plated |

Note: See other side for exploded pilot and housing assembly

| Catalog No. | Body | Pilot & Housing Assembly | Pipe Nipple 1/4" x 2" |
|-------------|----------|--------------------------|-----------------------|
| | Material | Material | Material |
| CFC2-A1 | Iron | Bronze with S.S. | Bronze 67586-03 |
| CFC2-A2 | Iron | Bronze with S.S. | Bronze 67586-03 |
| CFC2-C1 | Iron | Bronze with S.S. | Bronze 67586-03 |
| CFC2-A1 | Iron | Steel with S.S. | S.S. 67586-19 |
| CFC2-C1 | Iron | Steel with S.S. | S.S. 67586-19 |
| CFC2-A1 | Steel | Steel with S.S. | S.S. 67586-19 |
| CFC2-A2 | Steel | Steel with S.S. | S.S. 67586-19 |
| CFC2-C1 | Steel | Steel with S.S. | S.S. 67586-19 |

When Ordering, Please Specify

1. All Nameplate data
2. Item Number
3. Description
4. Material





Model CFC2 PILOT & HOUSING ASSEMBLY FOR FLOAT CHAMBER CONTROL

PARTS LIST

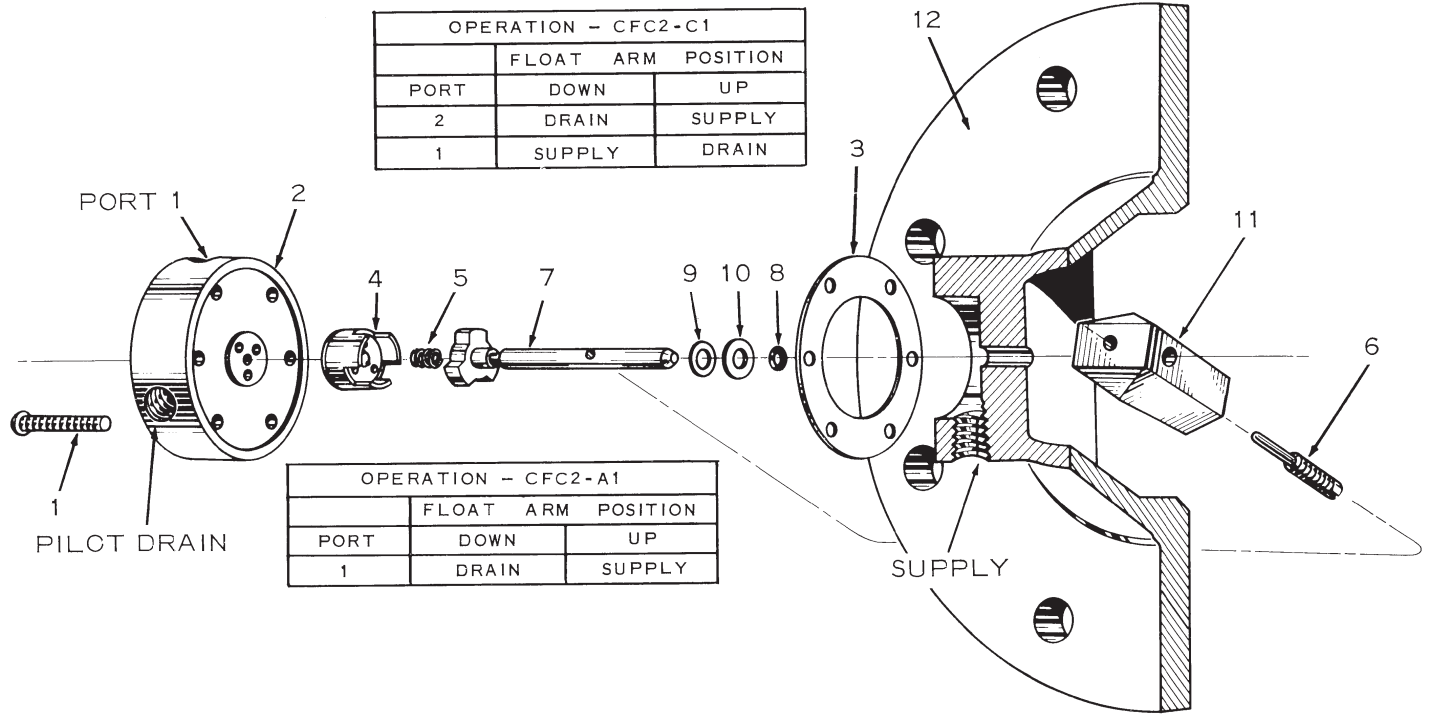

| Pilot & Housing Assemblies (Bronze with stainless steel) C426-1 for CFC2-A1 or CFC2-A2-3 C2035 for CFC2-A2 or CFC2-B2-3 C2149H for CFC2-C1 or CFC2-B2-4 | | |
|--|--|----------------|
| Item No. | Description | Material |
| 1 | Machine Screw, Rd. Hd., 6/32 x 1", 6 Required | Brass |
| *2 | Distributor for C426-1 Distributor for C-2035 Distributor for C-2149-1 | S.S. |
| *3 | Gasket | Buna-N® |
| *4 | Disc Assembly | Brass Monel |
| *5 | Spring | S.S. |
| 6 | Pin, Lock | S.S. |
| 7 | Stem Assembly | Brass S.S. |
| *8 | O-Ring | Buna-N® |
| 9 | Washer | Brass |
| 10 | Washer, Thrust | Brass |
| 11 | Arm, Float | Brass |
| 12 | Housing | Bronze |

| Pilot & Housing Assemblies (Bronze with stainless steel) C426-1 for CFC2-A1 or CFC2-A2-3 C2035 for CFC2-A2 or CFC2-B2-3 C2149H for CFC2-C1 or CFC2-B2-4 | | |
|--|--|----------------------|
| Item No. | Description | Material |
| 1 | Machine Screw, Rd. Hd., 6/32 x 1", 6 Required | Steel Cad. Plated |
| *2 | Distributor for C-8017 Distributor for 32340 Distributor for 30792 | S.S. |
| *3 | Gasket | Buna-N® |
| *4 | Disc Assembly | S.S. |
| *5 | Spring | S.S. |
| 6 | Pin, Lock | S.S. |
| 7 | Stem Assembly | S.S. |
| *8 | O-Ring | Buna-N® |
| 9 | Washer | S.S. |
| 10 | Washer, Thrust | S.S. |
| 11 | Arm, Float | S.S. |
| 12 | Housing | Steel |

When Ordering, Please Specify

1. All Nameplate data
2. Item Number
3. Description
4. Material

